

AXENT.ONE / AXENT.ONE^{PLUS}

You can control the AXENT.ONE shower toilet with the AXENT Smart Control App. Via Bluetooth, your mobile device automatically connects to the AXENT.ONE shower toilet and you operate it with just one finger. The app works like a normal remote control and controls every function – without ever touching the toilet. The AXENT Smart Control App can be installed and used on any Bluetooth-enabled Apple or Android device. You can modify and save settings.

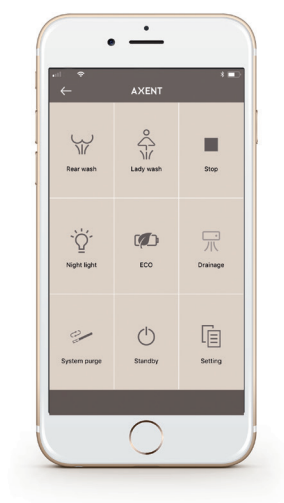

App installation

By searching the store, you can find the app under the following name:

Google Play Store: AXENT Remote Control



App Store for Apple: AXENT Remote Control



After installation, open the app

1. SETTING YOUR PRODUCT

AXENT has a variety of products that can be operated with this app. To select your product (AXENT.ONE / AXENT.ONE^{Plus}),

1.1 tap  SETTING

1.2 and tap once again on  SETTING

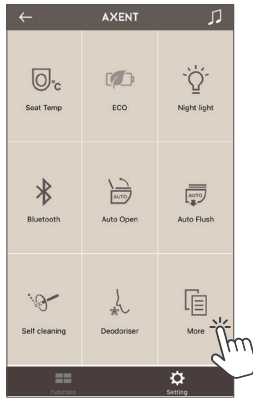
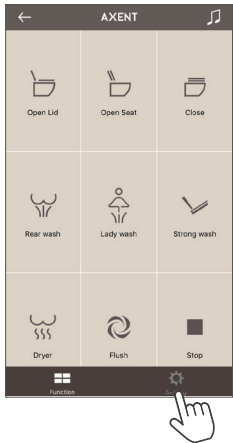

1.3 Select shower toilet via ABOUT / DEVICE INFORMATION

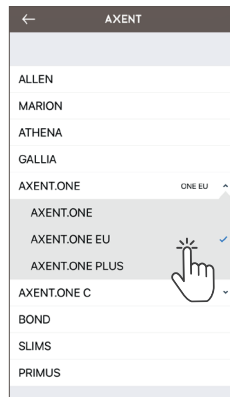
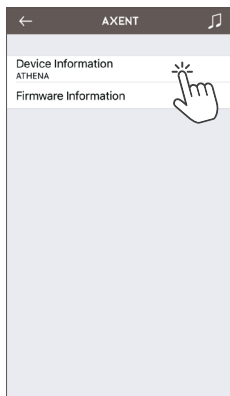
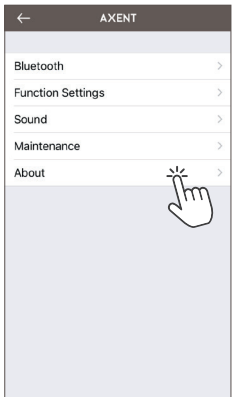

1.4 Nach der Auswahl des AXENT.ONE EU / AXENT.ONE PLUS erscheint die neue Frontseite mit den entsprechenden Funktionen.

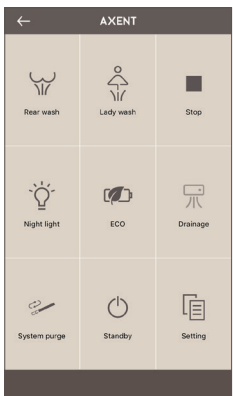

AXENT.ONE EU

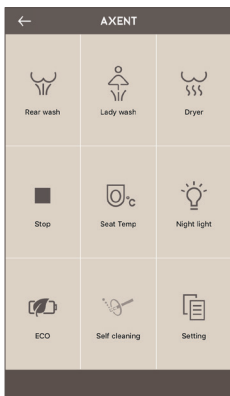

AXENT.ONE PLUS

2. CONNECTING THE APP WITH AXENT.ONE

Step near the shower toilet.

ATTENTION! Please make sure Bluetooth is activated on your phone.

2.1 Tap  SETTING

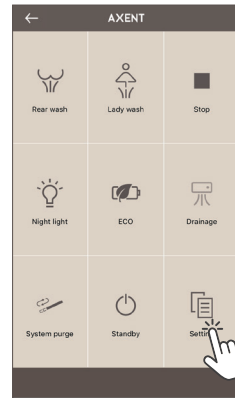

AXENT.ONE EU

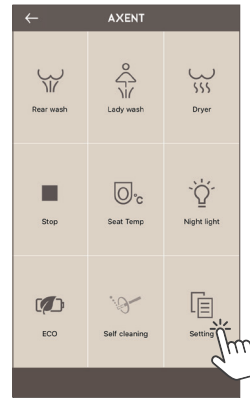

AXENT.ONE PLUS

2.2 then tap on BLUETOOTH

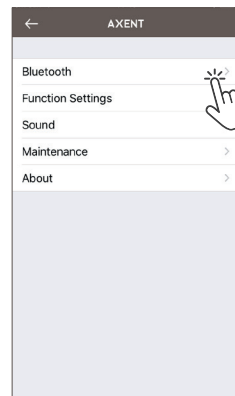

2.3 Tap on the displayed device AXENT_ONE_WC1P6.



2.4 Your phone and the AXENT.ONE are then connected. You hear a "BEEP"

2.5 Return to the home screen by tapping 2 x on the arrow ←

3. FUNCTION SETTINGS FOR THE AXENT.ONE

ATTENTION! AXENT.ONE^{Plus} has a user detection function. Only when it is activated can the shower or drying processes be started.

3.1 REAR WASH and LADY WASH

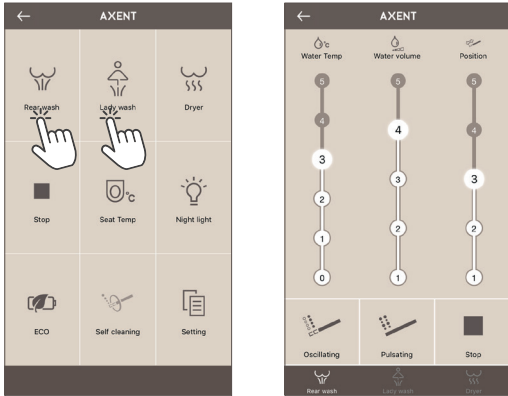

Set the shower function according to your personal needs. You have 5 levels to choose from. The oscillating and / or pulsating shower jet can also be activated. Water temperature position "0" means "cold water".

After enabling your desired setting, return to the home screen via the arrow ← or press Stop ■.

3.2 WARM AIR DRYER – Dryer temperature (AXENT.ONE^{Plus})

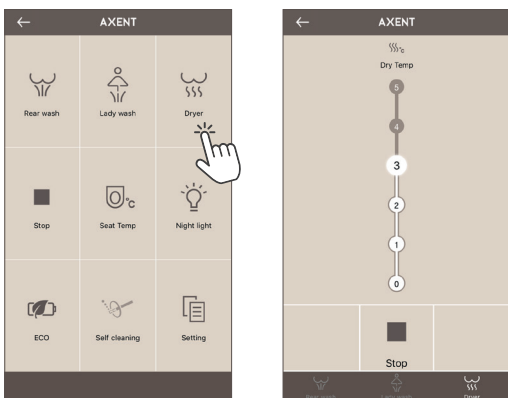

Set the dryer function according to your personal needs. You have 5 levels to choose from. Dryer temperature position "0" means "cold air".

After enabling your desired setting, return to the home screen via the arrow ← or press Stop ■.

4. "MANUAL SPRAY ARM CLEANING"

4.1 Tap SETTING

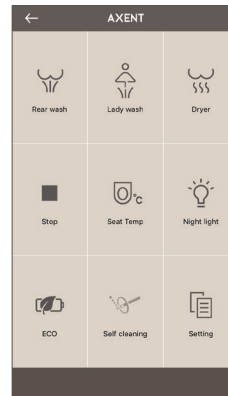

4.2 MAINTENANCE

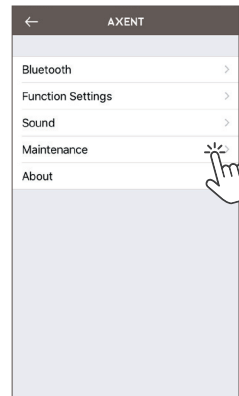

4.3 MANUAL SPRAY ARM CLEANING

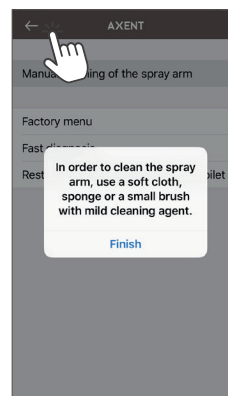
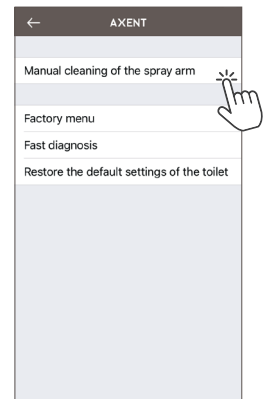

4.4 Spray arm extends outwards and can be cleaned. Once the cleaning is finished, press Done and the spray arm will retract again.

4.5 Return to home screen via arrow ←

5. ACCESSING VARIOUS FUNCTION SETTINGS

5.1 Tap SETTING

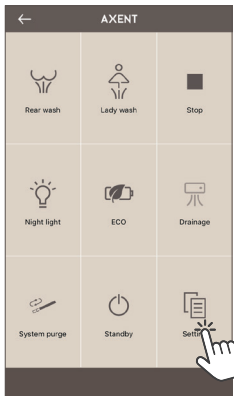

AXENT.ONE EU

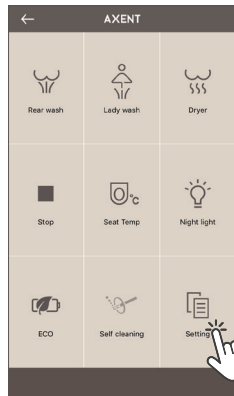

AXENT.ONE PLUS

5.2 FUNCTION SETTINGS

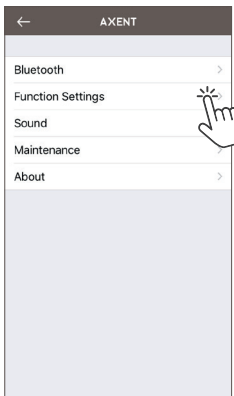

5.3 With regard to function settings, various functions can be activated and deactivated.

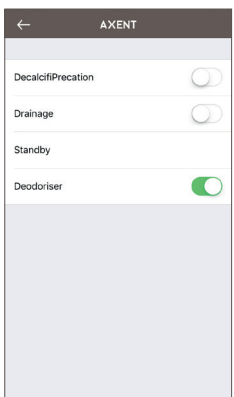

5.4 Return to home screen via arrow 